





NEWSLETTER

August 2023

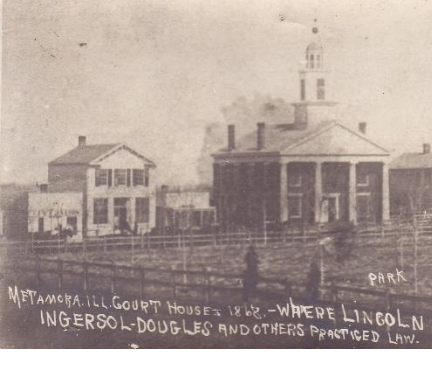

Like us on [Facebook](#) (Ctrl+click here)
www.historicmetamora.com

You've Seen This Property a Million Times... How many times have you walked or driven past this landmark building on the Square at **111 E. Partridge, Metamora** and maybe wondered about its past? Did you know that it has a long, rich history? Here's a glimpse of one of Metamora's most storied properties.

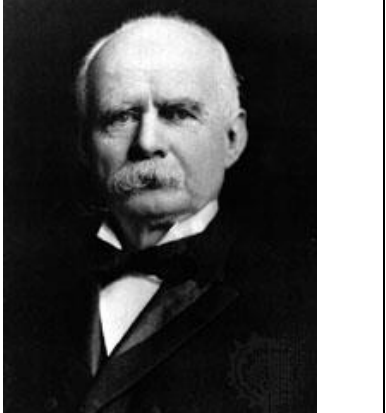
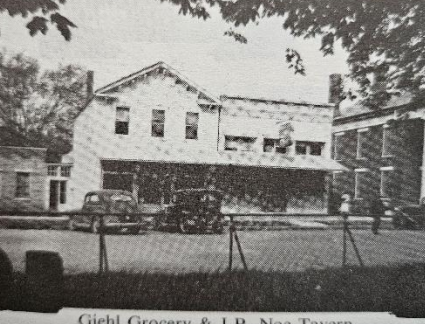
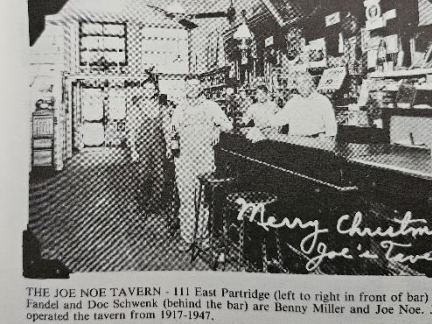
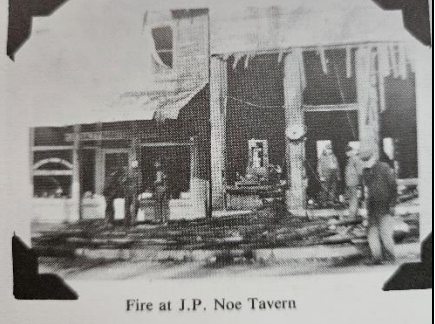
		
<p>Current home of John and Phyllis Dietel</p>	<p>Look closely – you'll see the building to the left of the Courthouse. It is not known what year it was built.</p>	<p>And supposedly this is Adlai S. is planting trees</p>
		
<p>The ladies had their own entrance on the east side of the saloon (pic around 1893-1900)</p>	<p>Adlai Stevenson age 30ish had a law office in this building (wife Letitia)</p>	<p>Adlai when he was VP of the U.S.A. under Grover Cleveland</p>
		
<p>Giehl Grocery and Noe Tavern. What year is the newest car?</p>	<p>The Joe Noe Tavern</p>	<p>Joe Noe's tavern caught fire (sometime in the 1940's)</p>

RICH HISTORY.

- Adlai Stephenson, who practiced law in Metamora from 1859 to 1869 and was vice president under Grover Cleveland, owned the property from 1865 to 1887.
- According to the abstract, Anheuser Busch Brewing Association purchased the building in 1904 from Jacob A, Strathman, "an unmarried man." Apparently, the structure had been a tavern for some time. (Sidenote: during Prohibition, many saloons turned to selling ice cream.)
- In 1919, Mabel McFarland sued the tavern for serving intoxicating liquor to her husband, causing his death. She won the case. See the details below.
- Joe Noe, who died in 1949, was another owner of the building. He removed the storage room and added a barred window where a door had existed. It seems his customers were slipping onto the room and pilfering his stock.
- An undocumented "urban legend" was that the property once passed ownership to pay off a gambling debt.
- This home of Phyllis and John Dietel was featured on the nationally televised HGTV show highlighting unique homes! Wonder what Adlai would have thought about that!

Here's facts from the old abstract... (Thanks to Phyllis Dietel for sharing this with the Newsletter...!)

- Woodford County was formed from a detached area of Tazewell County in 1841.
- Hanover was laid out by William Davenport on May 26, 1836. It was incorporated February 21, 1845 and its name was changed to Metamora.
- William Taylor sold William Davenport the land on June, 1836 for \$550.
- Davenport entered into a partnership with several others in a group called the Hanover Company to layout the town site, which was 282 acres.
- The survey for the town is based on "a stone fixed in the ground at the North East corner of the Public Square."
- September 16, 1865 John Clark sold "the east half of lot three in block twenty-eight in the town of Metamora" (now 111 E Partridge) to Adlai E. Stevenson for \$700. Warranty Deed.
- John Clark provided a mortgage deed to the property to A.E. Stevenson dated and filed on October 21, 1872 for \$383.
- A.E. Stevenson provided a release of mortgage to John Clark on January 10, 1887.
- Clark had several suits with James Colebank, Jonathan Cooper, Barnard Greaser, Emile Grieser, Benjamin Nichols that involved this property through 1887.
- Jacob Strathman provided a warranty deed to Anheuser Bush (sic) Brewing Association for \$3,000 on February 1, 1904.
- On September 8, 1919, Mabel McFarland brought suit against Joseph Noe, William Noe, and Max, Lewis for damages against the husband of the undersigned, that she intends to hold the property used and occupied by the said defendants in their saloon business at the time of said unlawful sales, said property being (this property) as liable in satisfaction of the damages. This suit charges the defendants with causing the death of the husband of Mabel McFarland, by reason of selling him intoxicating liquor. The case was submitted to jury on November 19, 1919 and the verdict of \$10,000 against Max Lewis for damages was rendered.
- Anheuser-Busch sold to Joseph P. Noe and Freida Noe the property on 12/7/36 for a\$100, Taxes for 1946 were \$54.44.
- Joseph Noe sold the property to William Nauman an option for 10 years on June 17, 1947 to purchase the property for the sum of \$10,200.
- Joseph Noe died on November 16, 1949 at the age of 66 years, 8 months, and 12 days and was buried at St. Mary's Cemetery.
- On November 28, 1949, Freida Noe sold the property to William Nauman. Nic and Betty Williams bought the property in October 1972; Bess Volz and Ron bought the property April 28, 1976.
- The Volz's sold to John and Phyllis Dietel on April 6, 1977.

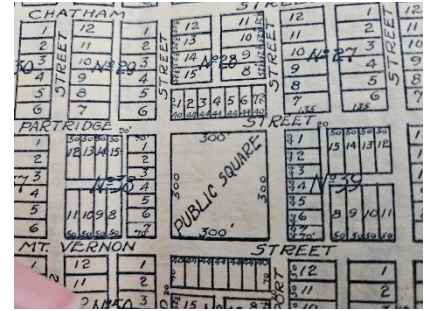

New Book Now Available from Ron Wagner Remembers Growing Up in Metamora

Ron has compiled a funny, nostalgic book about his childhood growing up in Metamora – mostly during the 60's. Titled "Growing Up in Metamora", it's filled with pictures and stories from the 60's. And it's FREE! To get an email copy, just email your request to Ron at Rwagner75013@gmail.com. By the way, Ron's grandfather was Joe Noe, who ran the saloon in the article above. Very interesting! You'll undoubtedly recognize some of the names and places – and experiences Ron talks about. You might even be mentioned. Here's a couple of pics from Ron's book...



Wombats

Jim Winn/Drums
Tom Byler/ Bass Guitar
Greg Volz/Guitar
John Briggs/Guitar



The Rockin R's

Ron Volz, Ron Wernsman
Ted Minar

Contact Us

Questions, ideas - Love to hear from you

Laure Adams, President, 369-2353 or jrfarmer@mtco.com; Dave Pohlman, Vice President 369-3290; pohlman46@yahoo.com 367-4426; Jim Efaw, Secretary, 367-6099 or jimefaw-mahp@eggroll.com; Jack Weddle, Treasurer, 645-0963, jweddle@mtco.com; Board members: Lee Summer, 367-4059, 635-0259, lsummer@mtco.com Mary Curry, 367-2185, curry@mtco.com; Rick Lotz, 648-2010, lots@mtco.com